



Vertical Control **Power Grip**

Congratulations on your purchase of the ProMaster Vertical Control Power Grip for the Sony A7III, A7RIII, and A9. This battery grip will provide longer shooting times for your camera, comfortable photography when taking vertical-orientation shots, and a more stable overall camera rig which reduces the chance of shake and blur.

To ensure proper operation, please read this manual thoroughly before using this product.

This grip is specially designed for the Sony A7III, A7RIII and A9 cameras. It is equipped with an alternate shutter button, front and rear main dials, multi-selector, and other buttons common to these cameras such as the C1 Custom button, C2 Custom button, and more. This battery grip can hold two NP-FZ100 batteries together in its tray. By using two batteries you double the shooting time of the camera. A second battery tray is included so you can make fast battery changes.

Warning

- This product should only be used with compatible devices specified in this instruction sheet.
- Use ONLY with the batteries and battery holders recommended.
- The vertical-grip operation switch (identified as the Lock Switch) is not a power switch; use the camera power switch to turn the power on/off.
- Do not have batteries installed in the grip when mounting it to the camera or removing it from the camera.
- Remove batteries from the grip when not in use for an extended period.
- Do not disassemble or repair this product yourself. Doing so will void your warranty.
- Avoid water or extreme humidity and be sure to store in a cool, dry location.
- Do not dispose of in fire or extremely high temperature environment.
- Keep the product and parts away from children to avoid hazard from swallowing.

Code 2803

Made in China

WWW.PROMASTER.COM | FAIRFIELD, CT 06825

Part Names

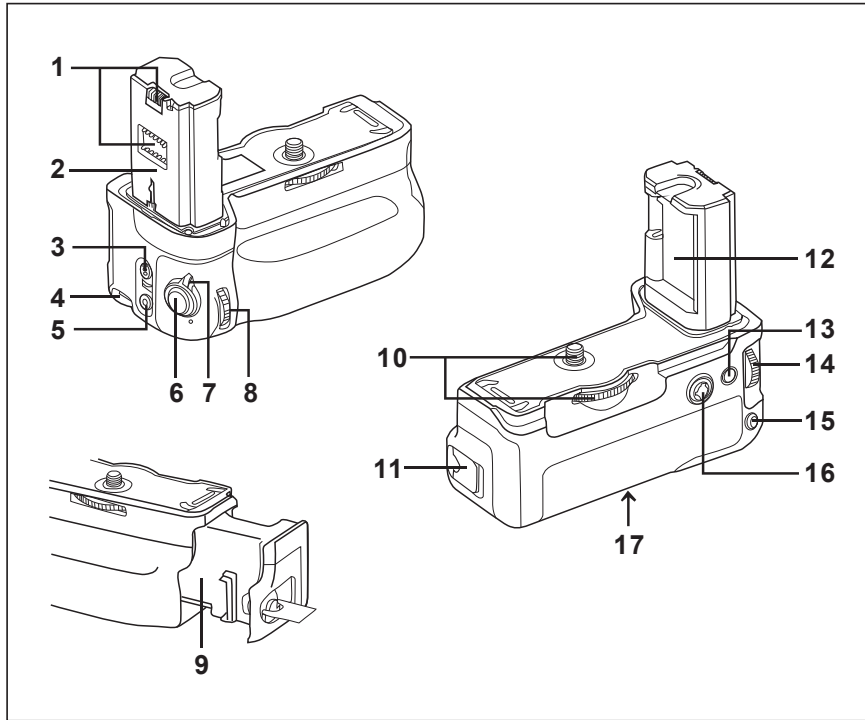

- 1) Electrical Contacts
- 2) Guide Bar
- 3) C2 Custom 2 Button
- 4) Strap Hook
- 5) C1 Custom 1 Button
- 6) Shutter Button
- 7) Lock Switch
- 8) Front Command Dial
- 9) Battery Tray
- 10) Attachment Screw and Attach/Detach Knob
- 11) Battery Chamber Latch
- 12) Camera Battery Compartment Cover Slot
- 13) AF-ON / Enlarge Button
- 14) Rear Command Dial
- 15) AEL / Image Index Button
- 16) Multi-selector
- 17) Tripod Socket

Troubleshooting

Symptom	Possible Solution
The camera does not work even after the grip is attached to the camera, the batteries are inserted into the unit and the camera POWER switch is set to ON.	Check that the camera Attachment Screw (10) is securely tightened. Check that the batteries are charged. Remove the batteries from Battery Tray (9), then re-insert. Set the camera POWER switch to OFF, remove the batteries, and remove then reattach the grip to the camera.
Shutter button or other operating buttons on the grip do not work.	Check that the Lock Switch (7) is not set to OFF. Remove the batteries from the Battery Tray (9), then re-insert. Set the camera POWER switch to OFF, remove the batteries, and remove then reattach the grip to the camera.
"InfoLITHIUM" battery only" is displayed on the camera.	Remove the batteries from the battery pack tray, then re-insert. Be sure you are using high quality, compatible batteries.

Specifications

Power Source	2 x NP-FZ100 batteries
Compatible Cameras	Sony A7III / A7RIII / A9
Operating Temperature	0°C to 40°C (32°F to 104°F)
Dimensions	Approx. 5" x 5 1/16" x 2 5/8" 127mm x 109mm x 67mm
Weight (without batteries)	Approx. 8.25 oz. 234g

One Year Unconditional Warranty

If for any reason, this ProMaster product fails within ONE YEAR of the date of purchase, return this product to your ProMaster dealer and it will be exchanged for you at no charge. ProMaster products are guaranteed for ONE FULL YEAR against defects in workmanship and materials. If, at any time after one year, your ProMaster product fails under normal use, we invite you to return it to ProMaster for evaluation.

Operation and Use of the Grip

1. Your camera is designed to use power from one battery at a time. It will automatically choose the battery with less power first. The camera's battery indicator icon will display the remaining power of the battery being used. When the battery being used is depleted (the in-camera icon will show this) the grip automatically switches to the next battery and the battery indicator icon will refresh.
2. Your camera must be turned ON for the grip to operate. When your camera is ON the grip may be switched ON or OFF using the Lock Switch (7). Please note, the grip will continue to supply power to your camera whether the Lock Switch (7) is set to ON or OFF. Setting the Lock Switch (7) to OFF only disables the operation of the grip's controls to prevent accidental changes to your settings and/or accidental taking of photographs.
3. Use the grip's Shutter Button (6) to comfortably auto focus and take photographs while holding your camera in a vertical position.
4. Use the buttons and command dials such as the C1 Custom 1 Button (5), C2 Custom 2 Button (3), AF-ON / Enlarge Button (13), AEL / Image Index Button (15), Multi-selector (16), Shutter Button (6), and Command Dials as you would on your camera. These controls work the same as they do on your camera. Refer to your camera's instruction manual for more information about how these buttons and controls work.
5. Use the Tripod Socket (17) to mount your grip and camera to a tripod or quick release plate.
6. This grip includes two NP-FZ100 battery holder trays so you can carry spare power and change battery trays very fast. However, always be sure to turn off power to your camera before changing batteries.

Attaching To Your Camera

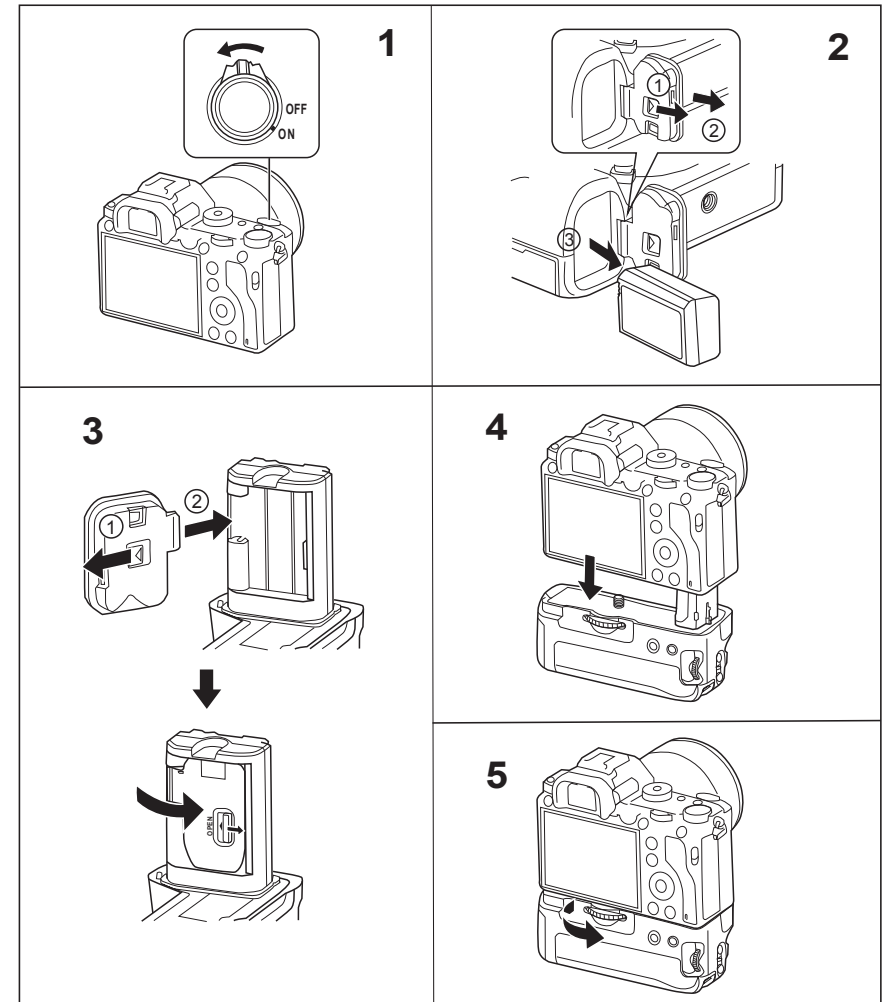

1. Be sure the camera is switched OFF.
2. Remove the battery in the camera. Then remove the camera's battery compartment cover by sliding the release switch on the inside of this cover and pulling the cover away from the camera body.
3. Store the camera's battery compartment cover in the grip's Camera Battery Compartment Cover Slot (12) by holding the release switch while attaching the cover to this part of the grip.
4. Attach the grip to the camera by lining up the Attachment Screw (10) with the camera's tripod socket and while carefully guiding the top of the grip into the camera's battery compartment.
5. Securely tighten the grip to the camera using the Attach/Detach Knob (10).

Installing The Batteries

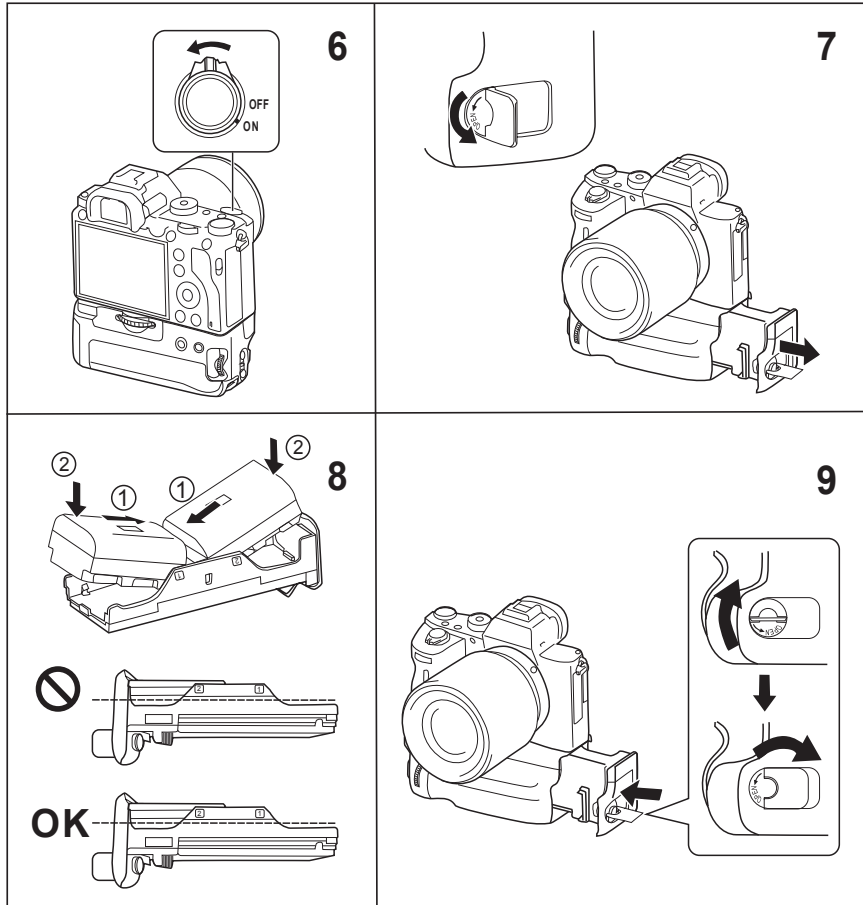

6. Be sure the camera is switched OFF.
7. Flip open the Battery Chamber Latch (11) and rotate it counterclockwise following the direction of the 'open' arrow on it. Now pull out and remove the Battery Tray (9).
8. Install two NP-FZ100 batteries into the Battery Tray (9) by pushing them down and into the tray starting at an angle as shown in the diagram. Be sure the battery contacts line up with the mating contacts in the tray. There are arrows and icons imprinted on the inside of the tray to further guide you.
9. Slide the Battery Tray (9) into the grip all the way. Rotate the Battery Chamber Latch (11) clockwise to secure the tray in place and then push it down for storage.

Note: it is OK to use just one NP-FZ100 battery with this grip. You may install one battery into either side of the tray and the grip and camera will operate properly.

Charging The Batteries

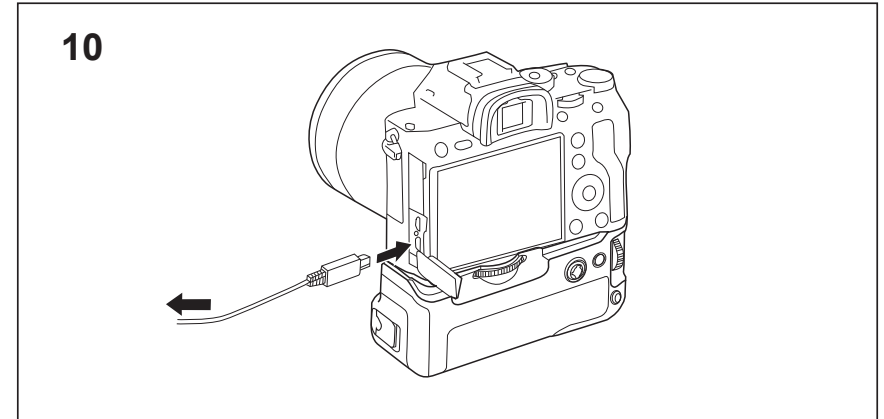

10. This grip is designed to work with the USB in-camera charging system already built into your camera. Be sure the camera is turned OFF and one or two batteries are properly installed in the grip. Use the USB charging cord and connect the camera to an AC wall outlet as you normally would. The charging indicator light on the camera will illuminate to indicate charging or the completion of a charging cycle just as it would normally. Two batteries in the grip will take twice as long to charge as one, assuming identical discharge levels. Refer to your camera's instruction manual for more information about USB in-camera charging.